

Bingham Farms - Jamestowne 31000 Building - 2,142 Sq. Ft



PROPERTY ADDRESS:

31000 Telegraph Road
Suite 210
Bingham Farms, MI 48025

SUITE SIZE: 2,142 Sq. Ft.

AVAILABLE: Immediately

FLOORPLAN: See page 2

LEASE RATE: Negotiable

LEASE TERM: Negotiable

DEMOGRAPHICS:

Oakland County, MI:

Population (2015): 1,243,970
Median household income (2015): \$67,465
Median house value (2015): \$178,900

Bingham Farms, MI:

Population (2015): 1,133
Median household income (2015): \$102,083
Median house value (2015): \$361,500



SUITE DESCRIPTION:

Nice 2nd floor office that features six (6) windowed offices; a nice reception upon entrance; small wet bar space with sink and counter and large open area in the middle. Other features include windows that open; individual control over HVAC and plenty of convenient parking just steps from building entrance.

JAMESTOWNE EXECUTIVE OFFICES

31000 TELEGRAPH ROAD, BINGHAM FARMS, MI.
SECOND FLOOR PLAN

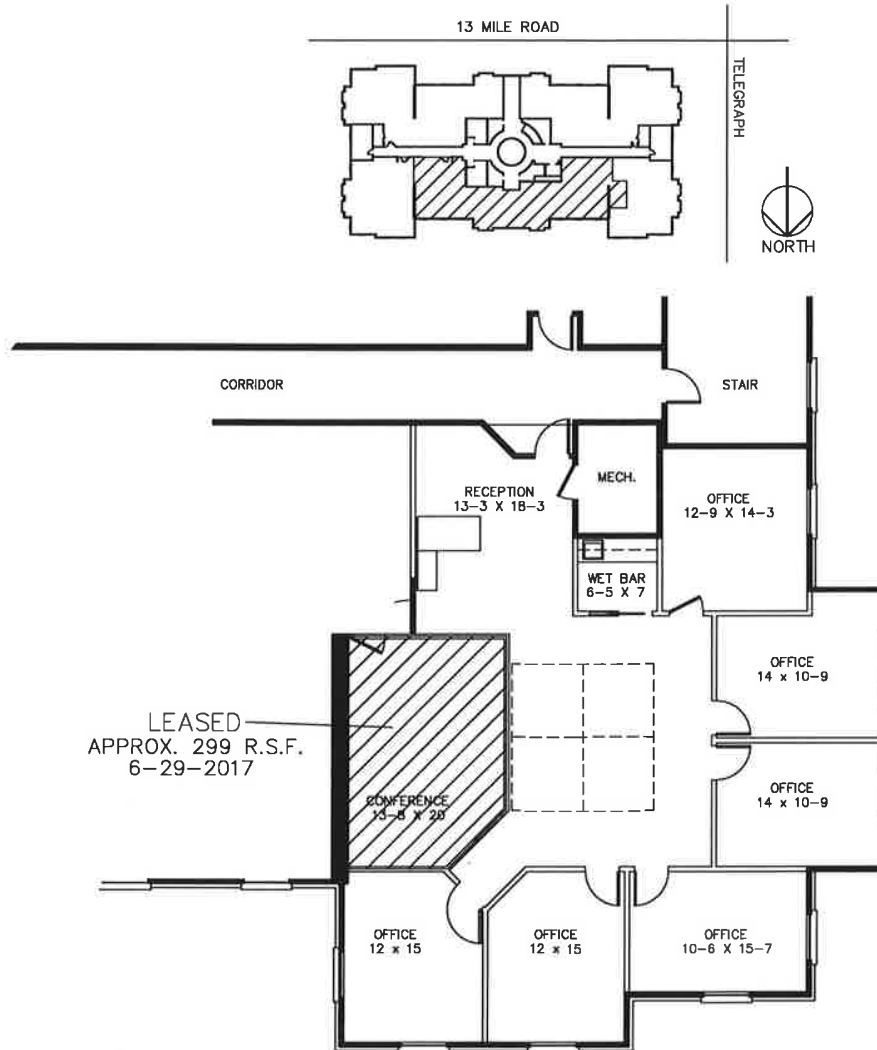

AVAILABLE
EXISTING SUITE # 210
APPROX. 2,142 R.S.F.
6-29-2017

Beachum & Roeser

MANAGEMENT & DEVELOPMENT CORPORATION

CALL:
BILL BEACHUM
248-647-7500