

Bingham Farms - Jamestowne South Building - 1,310 Sq. Ft



PROPERTY ADDRESS:

24255 W. Thirteen Mile Rd
Suite 160
Bingham Farms, MI 48025

SUITE SIZE: 1,310 Sq. Ft.

AVAILABLE: Immediately

FLOORPLAN: See page 2

LEASE RATE: Negotiable

LEASE TERM: 5 year term

DEMOGRAPHICS:

Oakland County, MI:

Population (2015): 1,243,970
Median household income (2015): \$67,465
Median house value (2015): \$178,900

Bingham Farms, MI:

Population (2015): 1,133
Median household income (2015): \$102,083
Median house value (2015): \$361,500



SUITE DESCRIPTION:

Nice suite immediately available at the beautiful Jamestowne South Executive Office Building. Suite features: A large waiting room and reception area upon entry to suite; two windowed offices; two non-windowed offices; and a copy/coffee room with sink and countertop. Other features include: windows that open; individual control over HVAC and plenty of convenient parking just steps from building entrance.

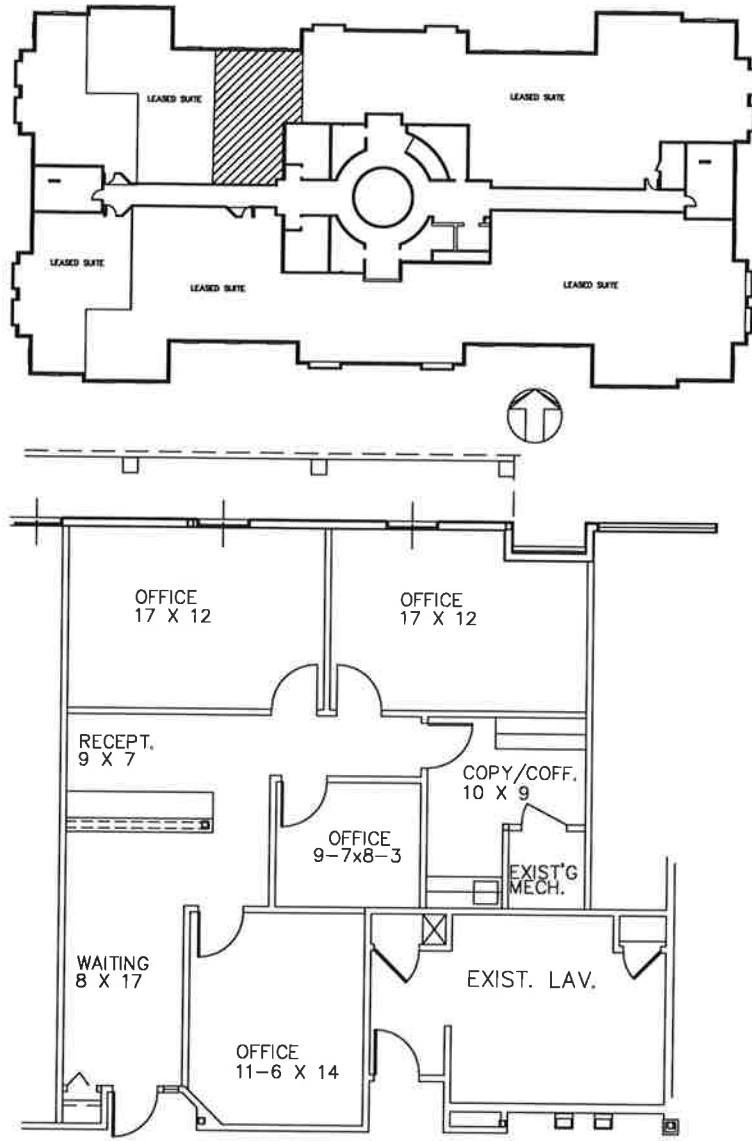

PARTIAL FIRST FLOOR PLAN

SCALE: 1/8" = 1'-0"

AVAILABLE FOR LEASE SUITE #160
 SPACE PLAN "A"
 APPROX. 1,310 R.S.F.

Beachum & Poeser

JAMESTOWNE SOUTH

24255 THIRTEEN MILE ROAD, BINGHAM FARMS, MI.
 CONTACT
 BILL BEACHUM
 248-647-7500