

Bloomfield Hills - Governor's Place Building - 2,253 Sq. Ft



PROPERTY ADDRESS:

33 Bloomfield Hills Parkway
Suite 242
Bloomfield Hills, MI 48304

SUITE SIZE: 2,253 Sq. Ft.

AVAILABLE: Immediately

FLOORPLAN: See page 2

LEASE RATE: \$25.00 PSF - general office

LEASE TERM: Negotiable

DEMOGRAPHICS:

Oakland County, MI:

Population (2015): 1,243,970

Median household income (2015): \$67,465

Median house value (2015): \$178,900

Bloomfield Hills, MI:

Population (2015): 42,112

Median household income (2015): \$112,154

Median house value (2015): \$350,600



SUITE DESCRIPTION:

Large 2nd floor suite available in Governor's Place located in Bloomfield Hills.

- 4 windowed offices
- 1 large corner, windowed office
- A large windowed conference room
- Entry into large waiting room
- Administrative area
- Coffee room w/ sink and countertop
- Storage room
- Windows that open
- Individual control over the HVAC
- Plenty of convenient parking

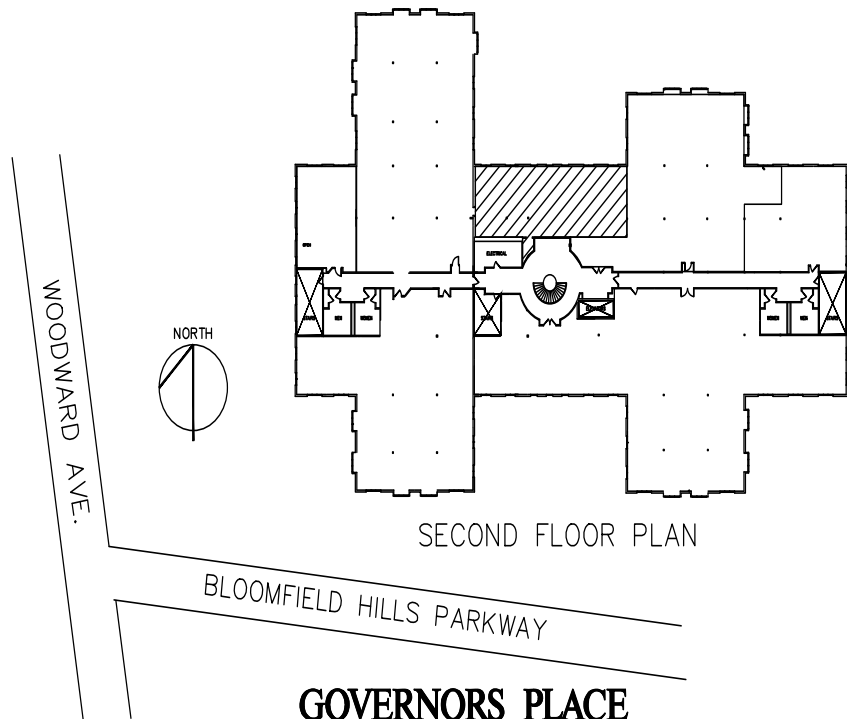

SECOND FLOOR PLAN

GOVERNORS PLACE

33 BLOOMFIELD HILLS PARKWAY
 BLOOMFIELD HILLS, MI.
 AVAILABLE FOR LEASE
 SUITE 242
 APPROX. 2,253 R.S.F.

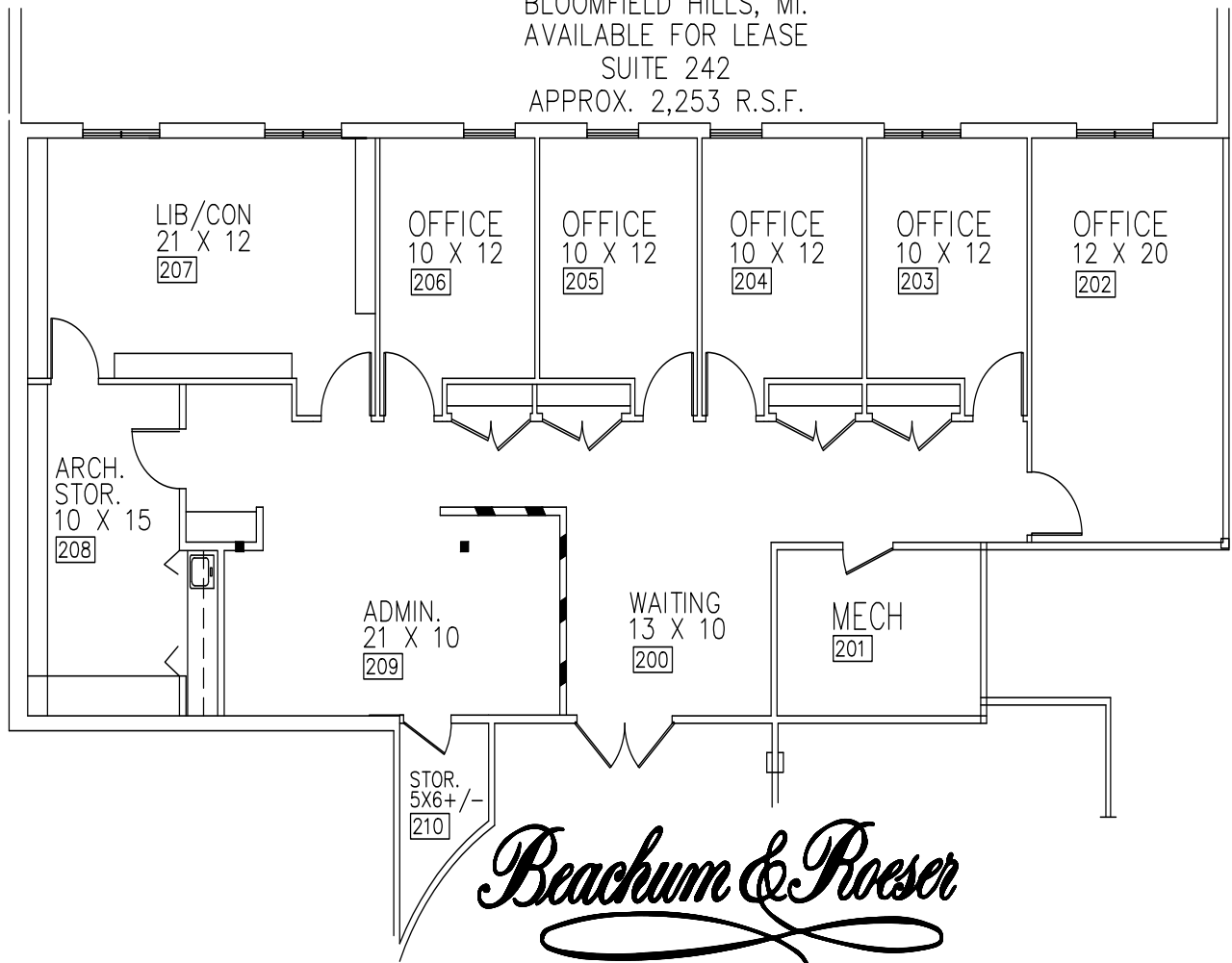

Beachum & Poeser

MANAGEMENT CORPORATION

CALL:
 BILL BEACHUM
 248-647-7500