

Troy, MI - Heritage Square - Suite 1771 - 2,480 Sq. Ft



PROPERTY ADDRESS:

1771 West Big Beaver Rd.
Troy, MI 48084

SUITE SIZE: 2,480 Sq. Ft.

AVAILABLE: Immediately

FLOORPLAN: See page 2

LEASE RATE: Negotiable

LEASE TERM: 5 year term

DEMOGRAPHICS:

Oakland County, MI:

Population (2015): 1,243,970
Median household income (2015): \$67,465
Median house value (2015): \$178,900

Troy, MI:

Population (2017): 83,813
Median household income (2017): \$95,825
Median house value (2017): \$297,600

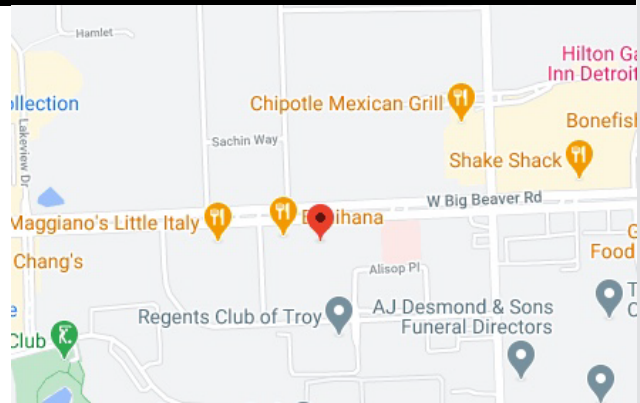

SUITE DESCRIPTION:

- 6 windowed offices
- 2 non-windowed offices
- Corner windowed conference room
- Waiting room upon entry
- Reception area
- Admin station
- File room
- Coffee room with sink & counter

Other features include: individual control over HVAC; windows that open and plenty of convenient parking.

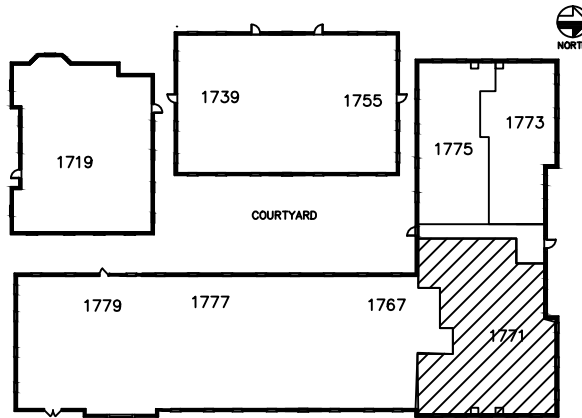

HERITAGE SQUARE

1771 WEST BIG BEAVER, TROY

AVAILABLE FOR LEASE
APPROX 2,480 SQ. FT.
AS-BUILT FLOOR PLAN

12-1-2020

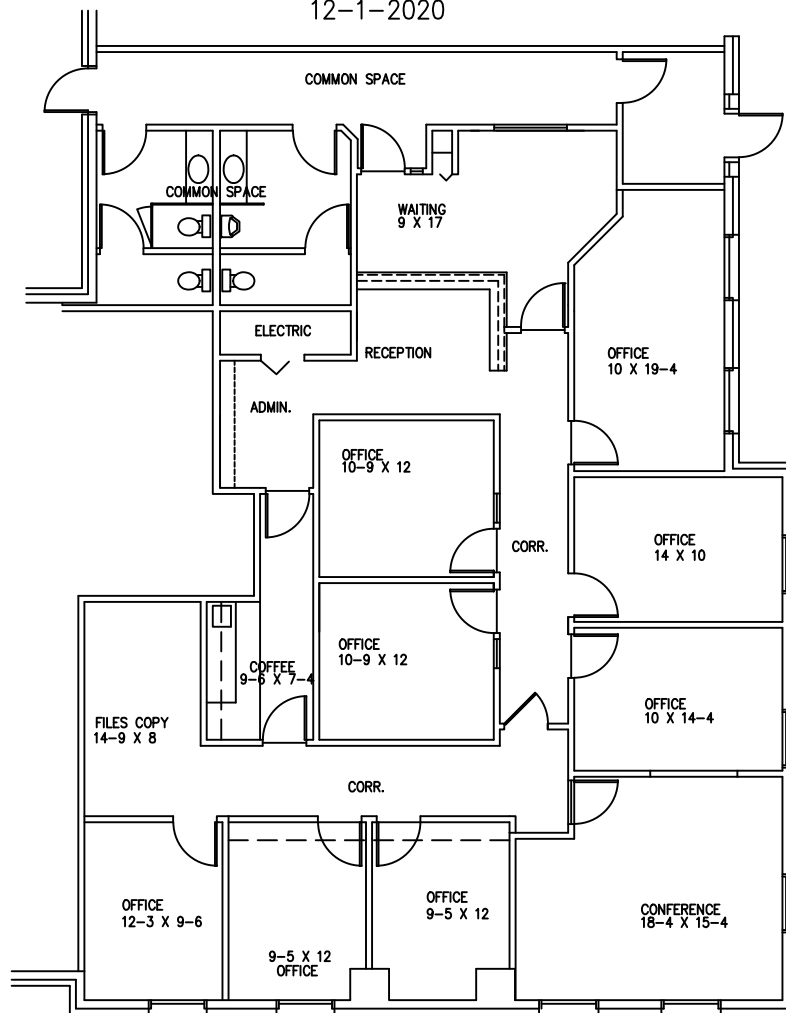

PARTIAL FLOOR PLAN

BEACHUM & ROESER
HERITAGE SQUARE
FARM BUREAU INSURANCE
EXISTING PLAN

SCALE: 1/8" = 1'-0"



DEVELOPMENT AND MANAGEMENT CORPORATION

CALL:
BILL BEACHUM
248-647-7500