

Bingham Farms - Jamestowne 31100 Building - 2,228 Sq. Ft



PROPERTY ADDRESS:

31100 Telegraph Road
Suite 240
Bingham Farms, MI 48025

SUITE SIZE: 2,228 Sq. Ft.

AVAILABLE: Immediately

FLOORPLAN: See page 2

LEASE RATE: Negotiable

LEASE TERM: Negotiable

DEMOGRAPHICS:

Oakland County, MI:

Population (2015): 1,243,970
Median household income (2015): \$67,465
Median house value (2015): \$178,900

Bingham Farms, MI:

Population (2015): 1,133
Median household income (2015): \$102,083
Median house value (2015): \$361,500



SUITE DESCRIPTION:

- Nice medical suite
- Waiting area with reception window
- 1 corner, windowed office
- A large corner procedure room
- Business office
- 4 exam rooms
- Lab area that has 2 sinks and 2 counters
- Kitchen with sink and countertop
- Charts area
- Medical waste room
- Private lavatories

Other features include: windows that open; individual control of HVAC and plenty of convenient parking.

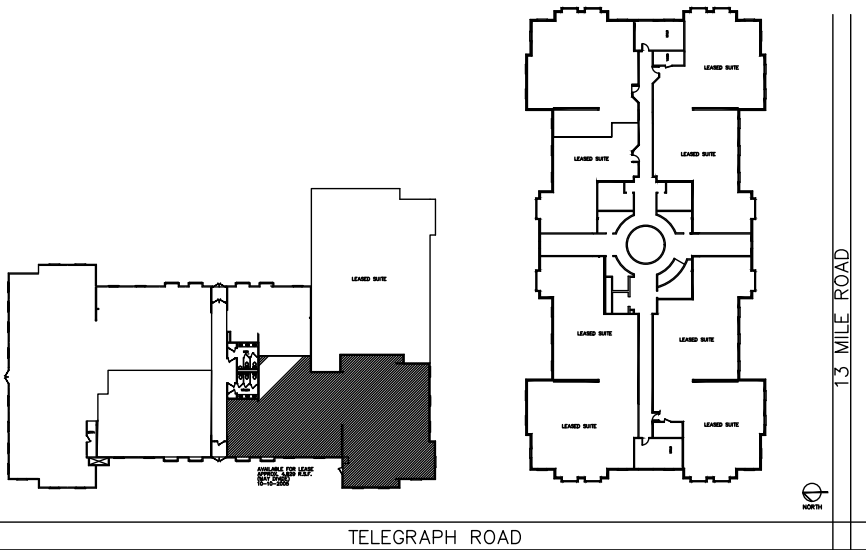

JAMESTOWNE EXECUTIVE OFFICES
 31100 TELEGRAPH ROAD, BINGHAM FARMS, MI.
 APPROX. 2,228 R.S.F.



MANAGEMENT & DEVELOPMENT CORPORATION

CALL:
BILL BEACHUM
 248-647-7500

