

Plymouth, MI - Pinehurst Building - 9,900 Sq. Ft



PROPERTY ADDRESS:

44670 Ann Arbor Road
Suite A
Plymouth, MI 48170

SUITE SIZE: 9,900 Sq. Ft.

AVAILABLE: Immediately

FLOORPLAN: See page 2

LEASE RATE: Negotiable

LEASE TERM: Negotiable

DEMOGRAPHICS:

Plymouth, MI:

Population (2005): 1,214,361

Median household income (2005): \$64,022

Median house value (2005): \$245,269

This large space can be broken into smaller suites, i.e., 2,500 sf, 3,100 sf and 4,300 sf. See plan diagrams.



SUITE DESCRIPTION:

- Foyer entrance into lobby reception area
- Over 45 individual offices, mostly windowed
- A large and small conference room
- (2) women's restrooms
- (2) men's restrooms
- (1) Unisex restroom
- Copy area and storage rooms
- Employee Lounge
- Availability July 2026

Windows that open; individual control over HVAC; plenty of convenient parking.

PINEHURST EXECUTIVE OFFICES
44670 ANN ARBOR RD
PLYMOUTH, MI

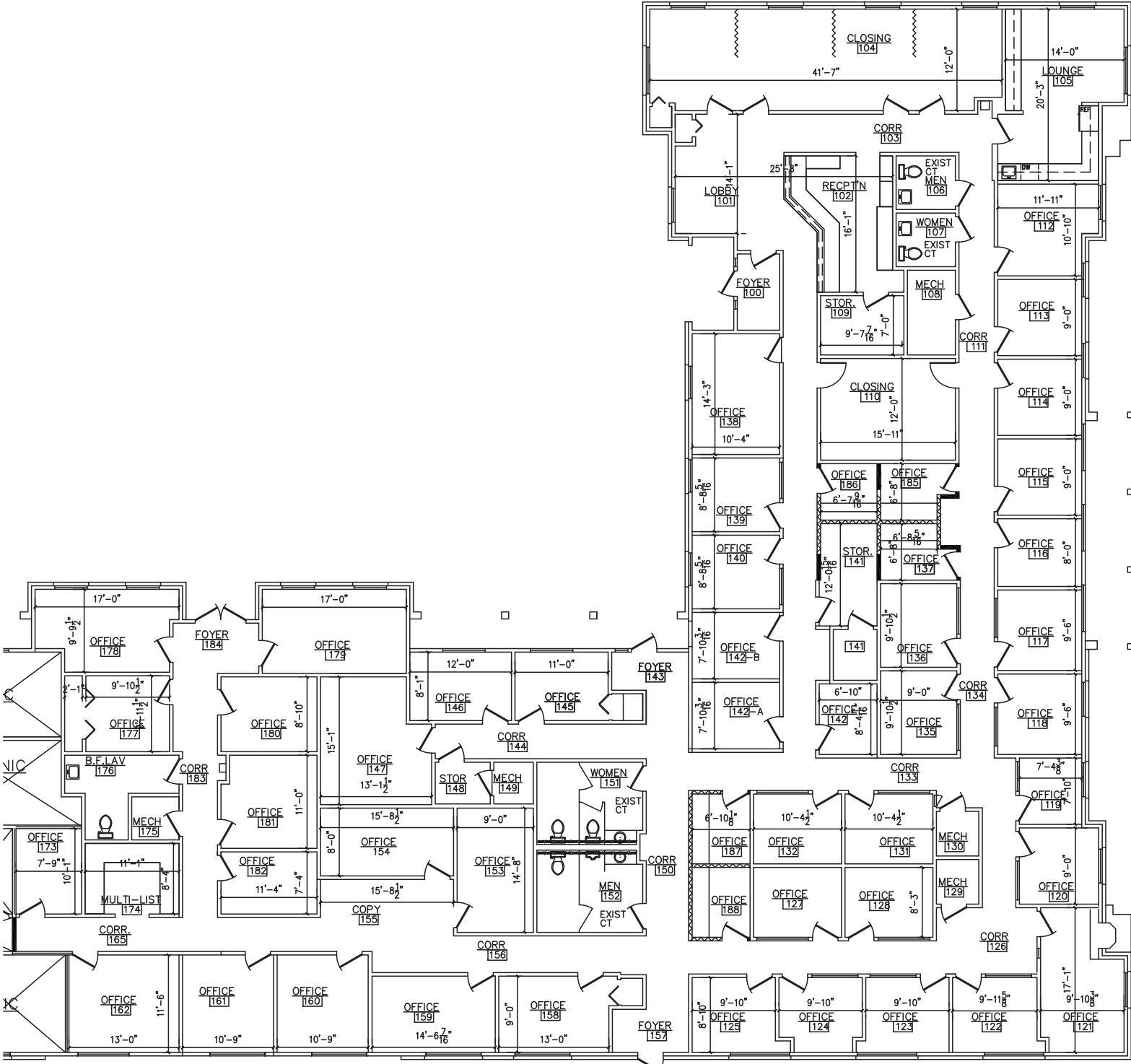

Beachum & Poeser

MANAGEMENT & DEVELOPMENT COMPANY
CALL:
BILL BEACHUM
248-647-7500

Potential Space Splits

